

PARKING TO BE SUSPENDED AS AND WHERE NECESSARY. CONSULT RELEVANT AUTHORITY.

AREAS OF WORKS (Pink hatched area)

NON-WORKING AREAS (Blue hatched area)

ALL SIGNAL HEADS AND BUTTONS TO BE COVERED OVER AND ADDITIONAL "TRAFFIC SIGNS NOT IN USE" SIGNS TO BE ATTACHED TO ALL POLES.

DO NOT SCALE FROM THIS DRAWING. All dimensions to be verified on site.

This drawing has been produced for the specific client and project identified below and is not intended for use by any other person or for any other purpose.
© Traffic Management Technical Services Ltd

- NOTES**
1. All signs as per Chapter 8. Distances between cones to be 3m maximum unless otherwise noted.
 2. All tapers to cones to be as per Chapter 8. Works are not permitted to be carried out within the taper.
 3. Minimum no. hazard lamps: 9 per 6m hazard width.
 4. Distances between signs NOT to scale for purposes of clarity.
 5. All sign placement subject to available safe working space.

KEY

- RR Red Route
- Cones
- No parking cones
- Double barrier
- Manual signal control where required.
- Signal head where required
- Hazard lamps if required.
- Aspect of sign vision.

A MINIMUM WIDTH OF 1.2m MUST BE ALLOWED FOR PEDESTRIAN ACCESS

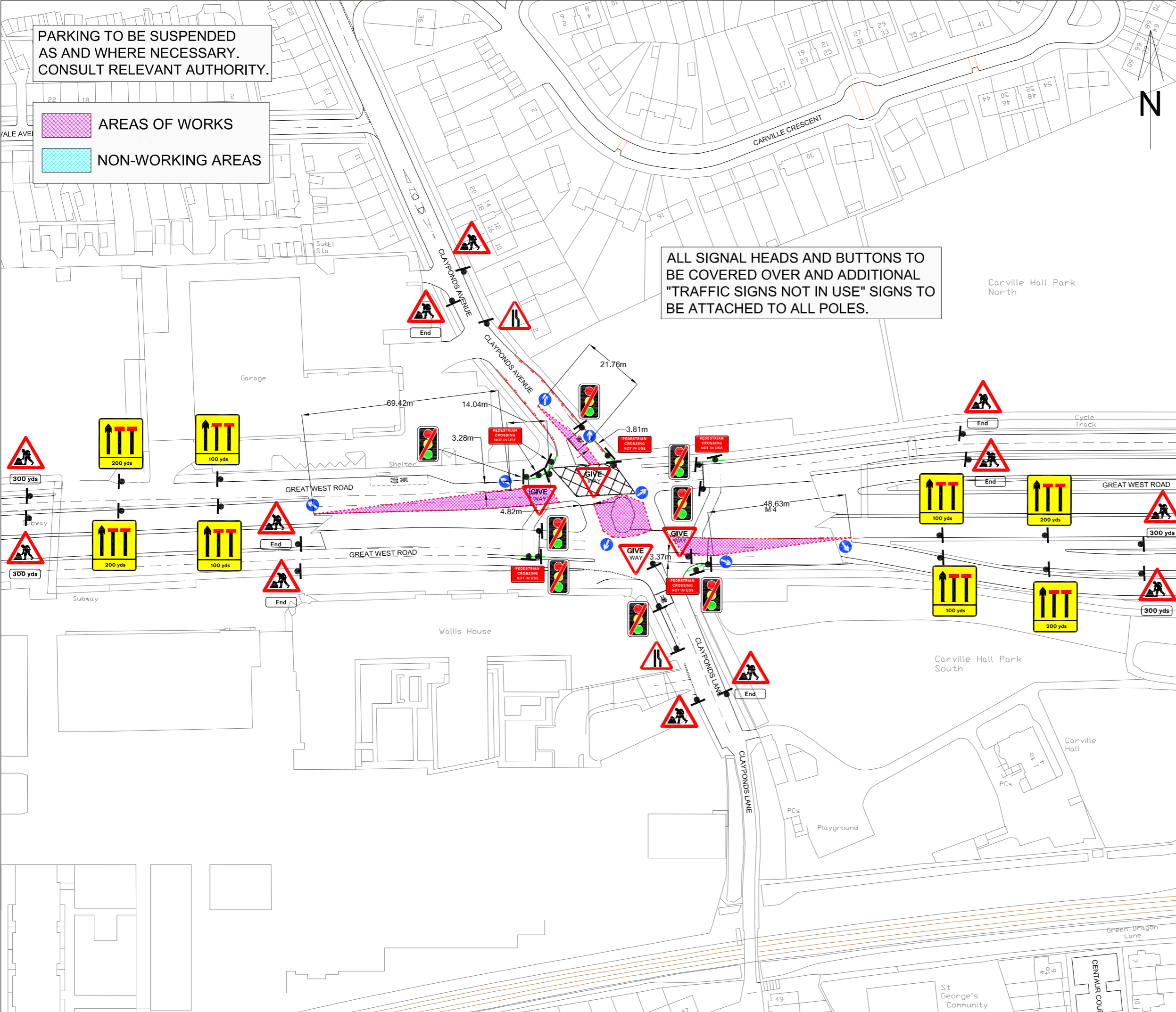

01	SIGNAGE AMENDED	19.01.12	RGS
REV.	DESCRIPTION	DATE	CHK

TRAFFIC MANAGEMENT TECHNICAL SERVICES LTD.

Telephone: 020 8667 9687 Web: www.drawingahead.com

ISO 9001 REGISTERED FIRM

scale at	date	drawn	chk1	chk2
1:1250 @ A3	13.01.12	RGS	RGS	AE

Working In Partnership With:

DIRECT TRAFFIC

Direct Traffic Management Ltd

Telephone: 01405 817733 Web: www.direct-traffic.co.uk

Project **LB OF HOUNSLOW**
A4 GREAT WEST ROAD / CLAYPONDS LANE / CLAYPONDS AVENUE
TRAFFIC MANAGEMENT
SHEET 1

DWG REF:	REV:
TM-PRO-25-042-04-001	01